

HYDRAULIC DIE ROLLERS

Models: HLR | HLK



Integrated hydraulic lifting system. Very heavy dies can easily be operated back and forwards or in all direction with ball type.

FUNCTION HYDRAULIC DIE ROLLER

- For transport of dies in and out the press
- Easy mounting in the T-slots of the press table
- Customized according to your specifications
- High Tech - low costs

THE ROLLER MODELS

- HLR – Hydraulic with rollers
- HLK – Hydraulic with balls

HLR (Roller)

Type	Lifting force unit	T-Slot (mm)	a	b	c	d	h
HLR 18	2000 N/200 bar	18	35	17	13	40	29,5 - 31
HLR 22	4000 N/200 bar	22	35	21	16	40	37,5 - 40
HLR 28	6000 N/200 bar	28	35	27	16	50	47,0 - 49,5
HLR 36	10 000 N/200 bar	36	35	35	16	90	60,5 - 63

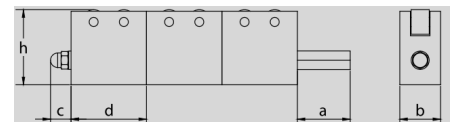

Fastening plate (Screw M5x12)

C	D	E	F	a	h
5,0	36	MS	8,0	18	30,0

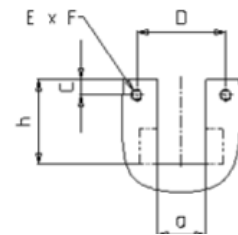

HLK (Ball)

Type	Lifting force unit	T-Slot (mm)	b	c	d	h	Min length
HLK 18	790 N/100 bar	18	17	3,5	30	30	105
HLK 22	1100 N/100 bar	22	21	3,5	40	40	140
HLK 28	1 500 N/100 bar	28	27	3,5	45	48	155
HLK 36	7500 N/100 bar	36	35	3,5	50	61	170

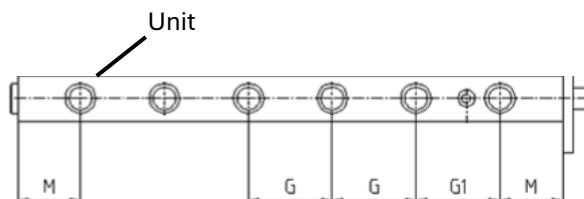

HYDRAULIC DIE ROLLERS AND CLAMPING



Integrated hydraulic lifting and clamping system for guiding, rolling and clamping

HYDRAULIC TWIN T-LEDGE HSR

- For transport of dies in and out the press
- Easy mounting in the T-slots of the press table
- Positioning and clamping the die with even force across the entire lower die.

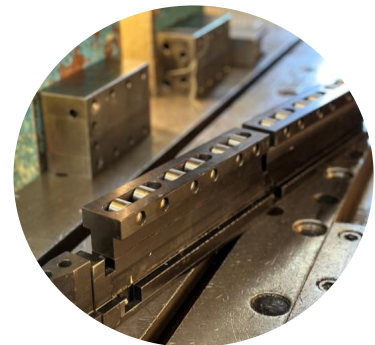

HYDRAULIC TWIN T-LEDGE HS

- For guiding and clamping the die. Mainly used for the ram

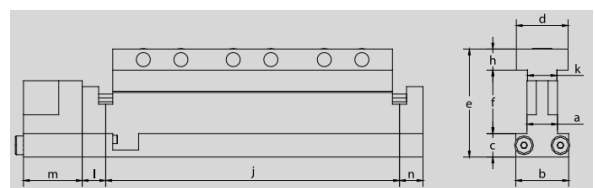

HR (Roller)

Type	Clamping force/pc	Lifting force/pc	a	b	c	d	e	f	h	j	k	l	m	n
HSR 22	23 kN/200 bar	32 kN/200 bar	21	36	15,5	35	73 - 79	42 - 48	15,5	250	20	20	50	35
HSR 28	31 kN/200 bar	44 kN/200 bar	27	45	19,5	44	92 - 98	53 - 59	19,5	250	26	20	50	35
HSR 1"	31 kN/200 bar	44 kN/200 bar	26,3	42	20	40	84,8 - 90,5	41,5 - 47,3	23,3	250	24	20	50	35

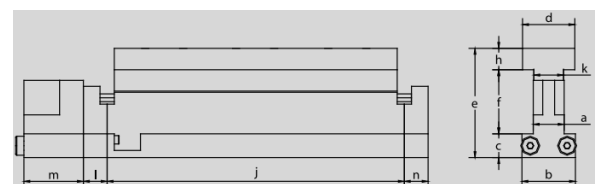

HS (Roller)

Type	Clamping force/pc	Lifting force/pc	a	b	c	d	e	f	h	j	k	l	m	n
HSR 22	23 kN/200 bar	32 kN/200 bar	21	36	15,5	35	73 - 79	42 - 48	15,5	250	20	20	50	35
HSR 28	31 kN/200 bar	44 kN/200 bar	27	45	19,5	44	92 - 98	53 - 59	19,5	250	26	20	50	35
HSR 1"	31 kN/200 bar	44 kN/200 bar	26,3	42	20	40	84,8 - 90,5	41,5 - 47,3	23,3	250	24	20	50	35

For inquiry or order:

- Specify max. die weight (W)
- Specify total roller length (L)
- Measure your T-slot (a, b, c, h)

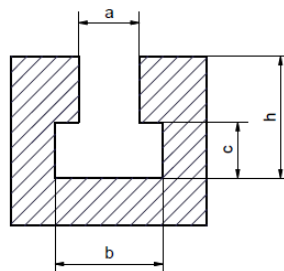

NOTE! To avoid any damage from roller or balls on the bottomside, the hardness of the die/adapterplate should be at least HRC58.

SWITZERLAND

Zehnder & Sommer AG
CH-3400 Burgdorf
info@zehndersommer.com
Tel +41 31 800 00 00

GERMANY

Zehnder & Sommer GmbH
DE-58452 Witten
info@zehndersommer.de
Tel +49 2302 981 60 30

zehndersommer.com
ZSswiss.com